

1ST FLOOR (16,579 SF): PHASE 1

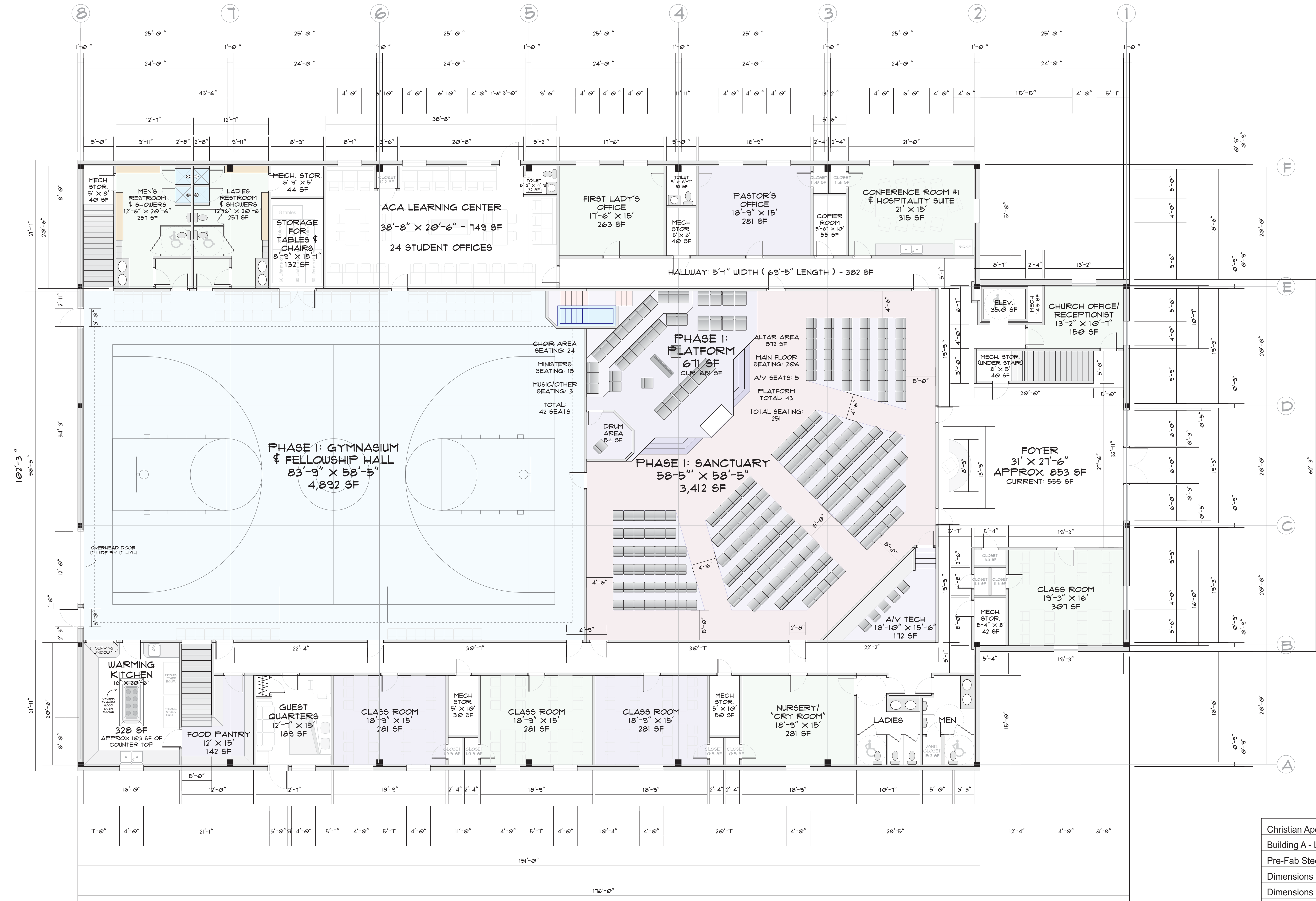

Christian Apostolic Church, Inc.
Building A - Lost Creek, WV
Pre-Fab Steel Building
Dimensions (main part): 151' x 102'-3" x 20'
Dimensions (w extension): 176' x 102'-3" x 20'
Drawing #: U-10a Page #: 4 (U-04c)
Drawing Date: June 4, 2014
Drawn by: Pastor Doug Joseph